

Property at Hwy 6 and Cast Houston, TX 77083 (Ft. Bend

Bissonnet at Hwy 6 and Claremont Drive

0 Bissonnet Street, Houston, TX 77083



713-385-2158
mchang@conveyanceRE.com

MICHAEL CHANG 713-
mchang@conveyanceRE.com

Michael Chang
Conveyance Real Estate LLC
4900 Fournace Pl, Suite 500, Bellaire, TX 77401
mchang@conveyanceRE.com
(281) 823-7723

Bissonnet at Hwy 6 and Castle on, TX 77083 (Ft. Bend C



JOHN FURNACE 713-385-2158
jfurnace@conveyanceRE.com

MICHAEL CHANG 713-714-5800
mchang@conveyanceRE.com

Price:	\$3,411,360
Property Type:	Land
Property Subtype:	Commercial
Proposed Use:	Commercial
Sale Type:	Investment
Total Lot Size:	6.52 AC
No. Lots:	1
APN / Parcel ID:	4295-02-000-0012-907

Bissonnet at Hwy 6 and Claremont Drive

\$3,411,360

Prime investment opportunity for owner, user, or developer. Suitable for residential, commercial, office condo, or mini storage development(s). Unrestricted 6.52 acres with shared detention pond for more effective land usage. Approximately 700' of frontage on Bissonnet Street. This does not get any better!...

Prime investment opportunity for owner, user, or developer. Suitable for residential, commercial, office condo, or mini storage development(s). Unrestricted 6.52 acres with shared detention pond for more effective land usage. Approximately 700' of frontage on Bissonnet Street. Buyer to order updated survey....

- Minutes north of Sugar Land
- Located at the Four Corners of Highway 6 and Bissonnet in growing Ft. Bend County
- Development ready with infrastructure and shared detention

Shared Detention Pond North of Property Equivalent to ~20,000 SF of Useable Land

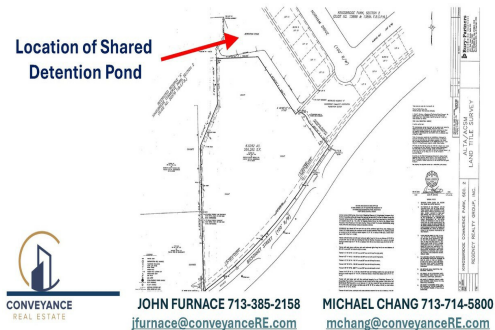

Excellent Development Potential Residential/ Commercial/ Office Condos

~6.53 acres – Unrestricted

Shared Detention Pond – a Plus!

Next to Established Retail and Residential Developments

Significant Frontage on Bissonnet



JOHN FURNACE 713-385-2158
jfurnace@conveyanceRE.com

MICHAEL CHANG 713-714-5800
mchang@conveyanceRE.com

0 Bissonnet Street, Houston, TX 77083

Prime investment opportunity for owner, user, or developer. Suitable for residential, commercial, office condo, or mini storage development(s). Unrestricted 6.52 acres with shared detention pond for more effective land usage. Approximately 700' of frontage on Bissonnet Street. This does not get any better!

Unrestricted ~6.53 Acres Next to Major Developments



JOHN FURNACE 713-385-2158
jfurnace@conveyanceRE.com

MICHAEL CHANG 713-714-5800
mchang@conveyanceRE.com